



NIPPON HAKUYOHIN KENTEI KYOKAI
(The Ship Equipment Inspection Society of Japan)

CERTIFICATE OF RECEPTACLE
FOR DANGEROUS GOODS

Certificate No. 24OS-t-2816

Kind and Type	Packaging of Small size Steel Jerricans (non-removable head) KP1L
Name or Title and Address of Applicant	Fujii Yohki Industries Co., Ltd. 6-19, Higashi-nakahama, 8-chome, Johto-ku, Osaka, Japan
Name or Title of Manufacturer	Fujii Yohki Industries Co., Ltd. Nara Factory
Manufacturer's Serial Number
Remarks	Marking:  3A1/Y 1.6/100/YR J/HK/FYN YR means the last two digits of the year during which the packaging was manufactured is to be marked on the packagings. Quantity : 50000 pieces Manufacture Duration of Packagings : Until 11 May 2025

This is to certify that the receptacle identified above has been inspected as shown on the attached paper and that this receptacle conforms to the requirements of Part 4 and Part 6 of IMDG Code. This certificate is issued in accordance with the provision of Article 113, Paragraph 3 of the Regulations for the Carriage and Stowage of Dangerous Goods by Ships (Ministry of Transport Ordinance No.30 of 1957) as amended.

Date 12 May 2024

Surveyor KITAMURA Isao
NIPPON HAKUYOHIN KENTEI KYOKAI

Note NIPPON HAKUYOHIN KENTEI KYOKAI is a designated National Competent Authority which is listed in the list of paragraph 7.9.3 of IMDG Code.

TEST REPORT OF PACKAGING

Test Report No. 24OS-t-2816

Date of Report 12 May 2024

1. Kind of Packaging : Steel Jerricans (non-removable head)
2. Type of Packaging : KP1L
3. Name and Address of Test Facility : Fujii Yohki Industries Co., Ltd. Nara Factory
1149-8, Kitatawara-cho, ikoma, Nara, Japan
4. Name and Address of Applicant : Fujii Yohki Industries Co., Ltd.
6-19, Higashi-nakahama, 8-chome, Johtoh-ku, Osaka, Japan
5. Date of Test : 10 May 2024
6. Name and Address of Manufacturer : Fujii Yohki Industries Co., Ltd. Nara Factory
1149-8, Kitatawara-cho, ikoma, Nara, Japan
7. Description of the Packaging Design Type : Refer to attached drawings.
8. Maximum Capacity : 1.2 litres
9. Characteristic of Test Contents : Water
10. Test Descriptions and Results :

Test Items	Test Standard		Test Results
General Inspection:			Good
Drop Test:IMDG Code Chapter 6.1.5.3	Drop Height	1.6 m	Pass
Leak Test:IMDG Code Chapter 6.1.5.4	Test Pressure	20 kPa	Pass
Pressure Test:IMDG Code Chapter 6.1.5.5	Test Pressure	100 kPa	Pass
Stacking Test:IMDG Code Chapter 6.1.5.6	Stacking Load	35 kg	Pass



Surveyor KITAMURA Isao

NIPPON HAKUYOHIN KENTEI KYOKAI

The packaging prepared as for transport was tested in accordance with the appropriate provisions of the IMDG Code. The use of other packaging methods or components may render it invalid.

型式	KP1L	
寸法 (mm) (±1.0)	61.0×121.0×18.0	
風袋重量 (キャップ付) g	16.00±1.0	
材質	天板	ふりき (JIS G 3303) 板厚 0.28mm
	底板	ふりき (JIS G 3303) 板厚 0.28mm
	側板	ふりき (JIS G 3303) 板厚 0.24mm
	天、底、側板 合方法	三重巻縮め
巻縮め充填剤メーカー名	福岡パッキング (株)	
及び品名	S365	
側部合方法	溶接	

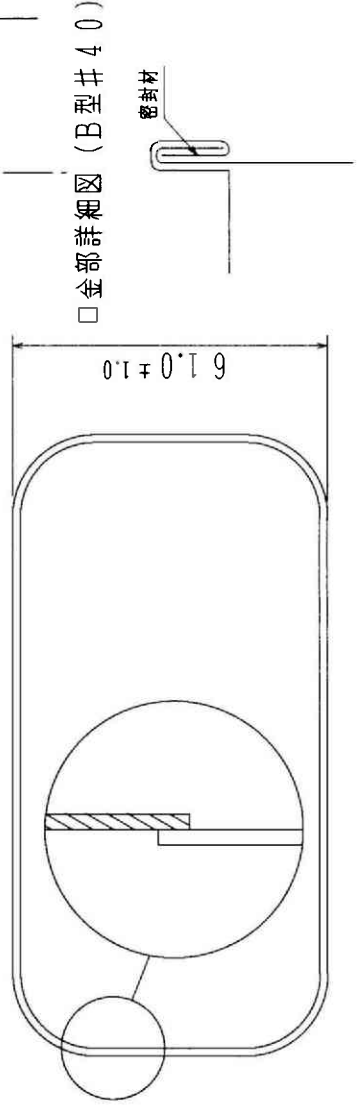
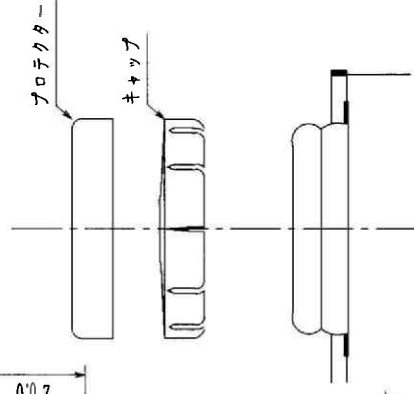
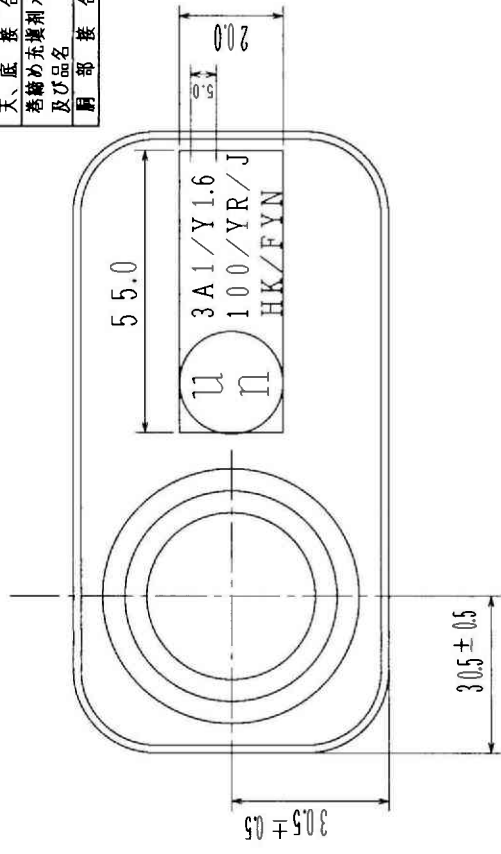
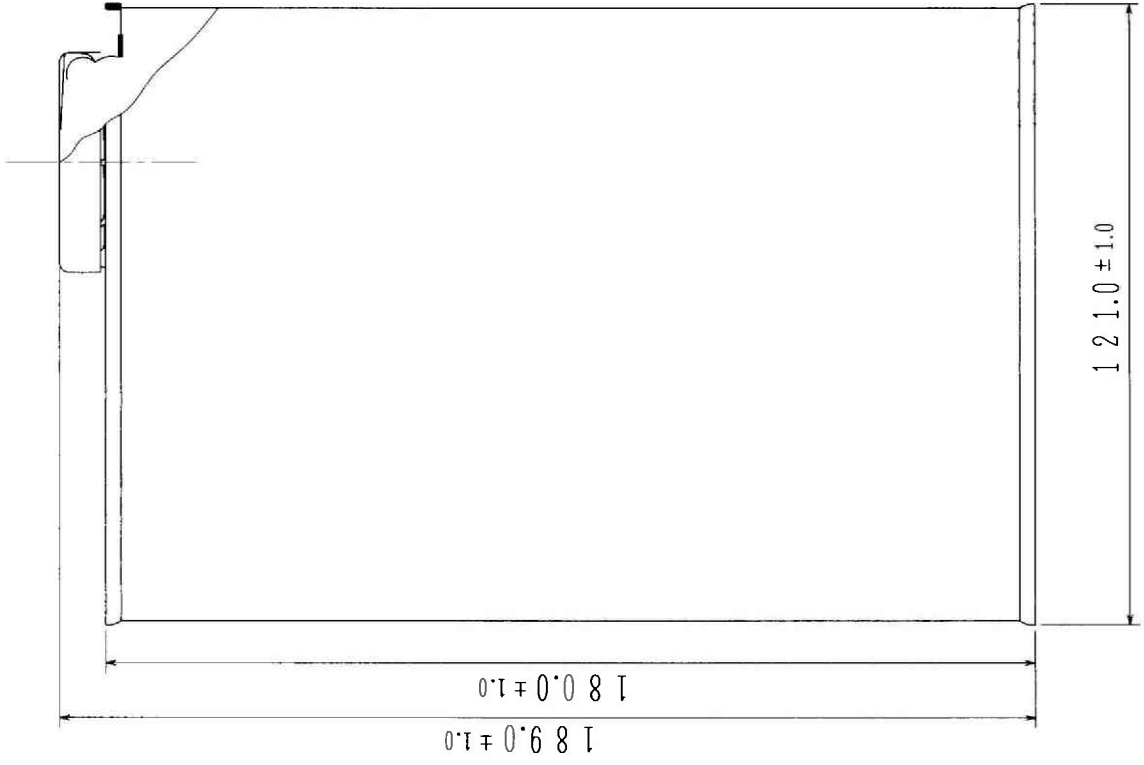

□金部詳細図 (B型#40)

巻縮め部詳細図

品名	KP1L	尺度	
出図	2024.4.17		
	藤井容器工業株式会社		図番